

**NOTE:** Instruction for synchronizing the carburetors is found in the RV-12 Maintenance Manual. Complete all sections of the RV-12 Assembly Instructions prior to synchronizing the carburetors.

**NOTE:** The remaining steps in this section provide cable installation for the right carburetor. Cable installation on the left carburetor is a mirror of the right and should be done at the same time.

**Step 1:** Install the conduit of the right Throttle Cable (the longer of the two cables) to the cable bracket using the hardware called out in Figure 1. Adjust the nuts so that the cable bracket will be approximately centered on the threaded portion of the conduit, then tighten.

**Step 2:** Thread the Throttle Cable lead through the CT-00101 Stop Nut and into the hole in the shank of the VA-219 RV-12 Control Cable Bolt. Loosely attach the throttle arm hardware as called out in Figure 1.

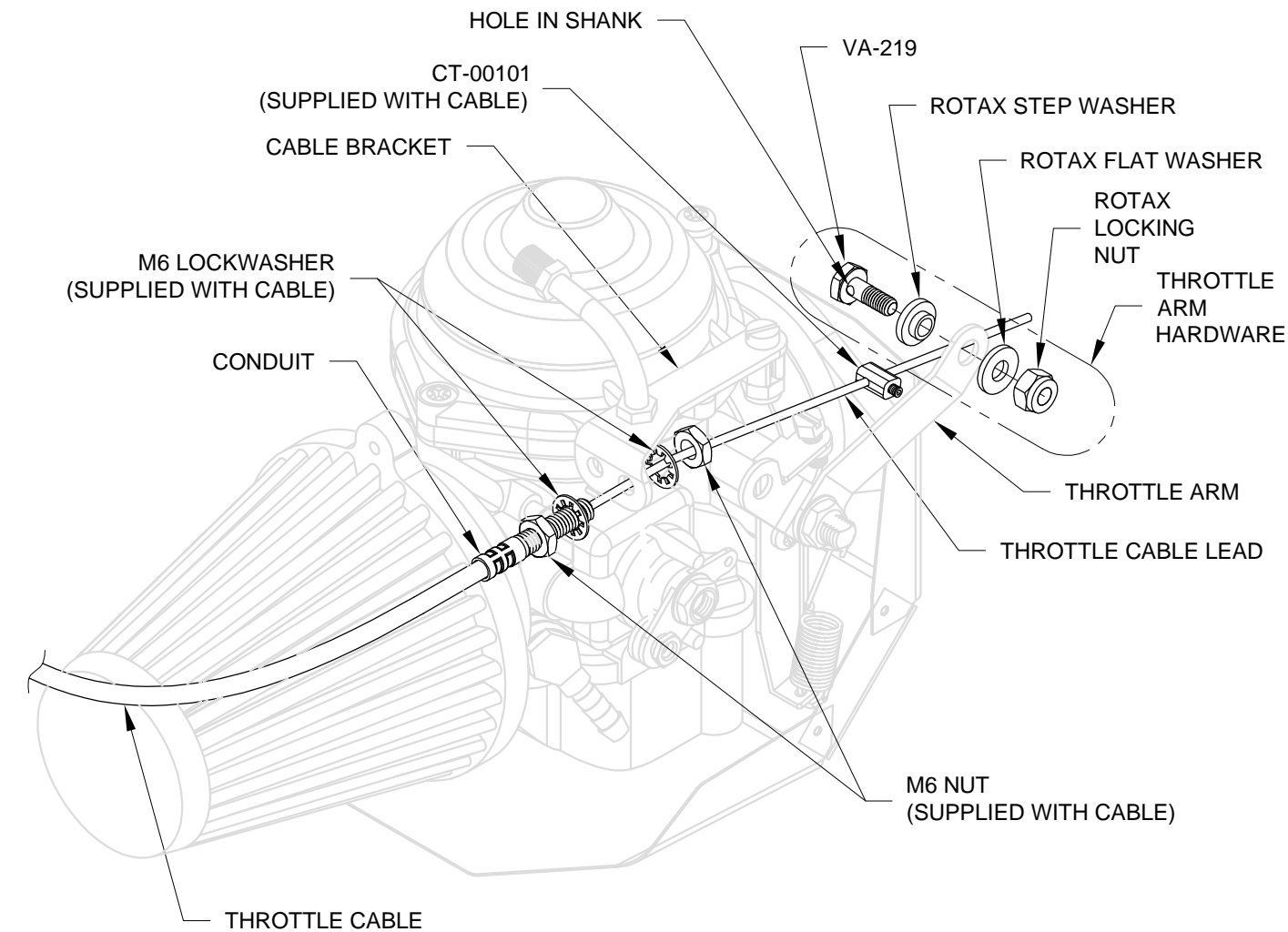

**FIGURE 1:**  
THROTTLE CABLE TO CARB CONNECTION

**Step 3:** Push the Throttle Cable handle all the way in to the friction adjustment as shown in Figure 2. Temporarily tighten the friction adjustment.

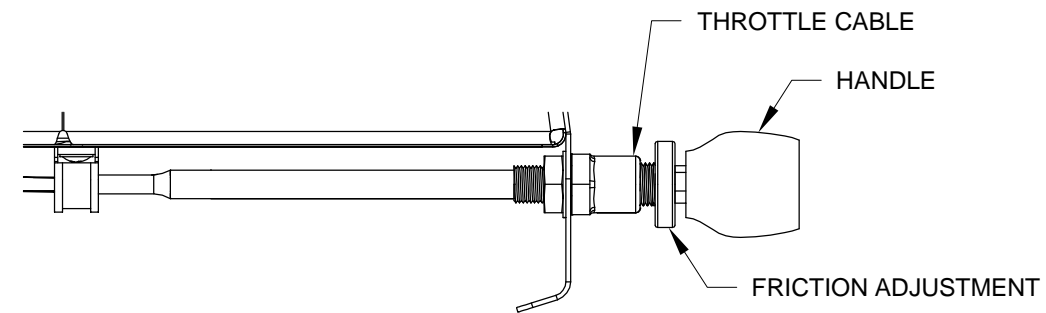

**FIGURE 2:** THROTTLE HANDLE POSITION

**Step 4:** Let the automatic full throttle return spring move the throttle arm all the way forward (note the throttle arm hardware will need to be loose enough to allow this to happen). Trim the Throttle Cable lead to the dimension given in Figure 3.

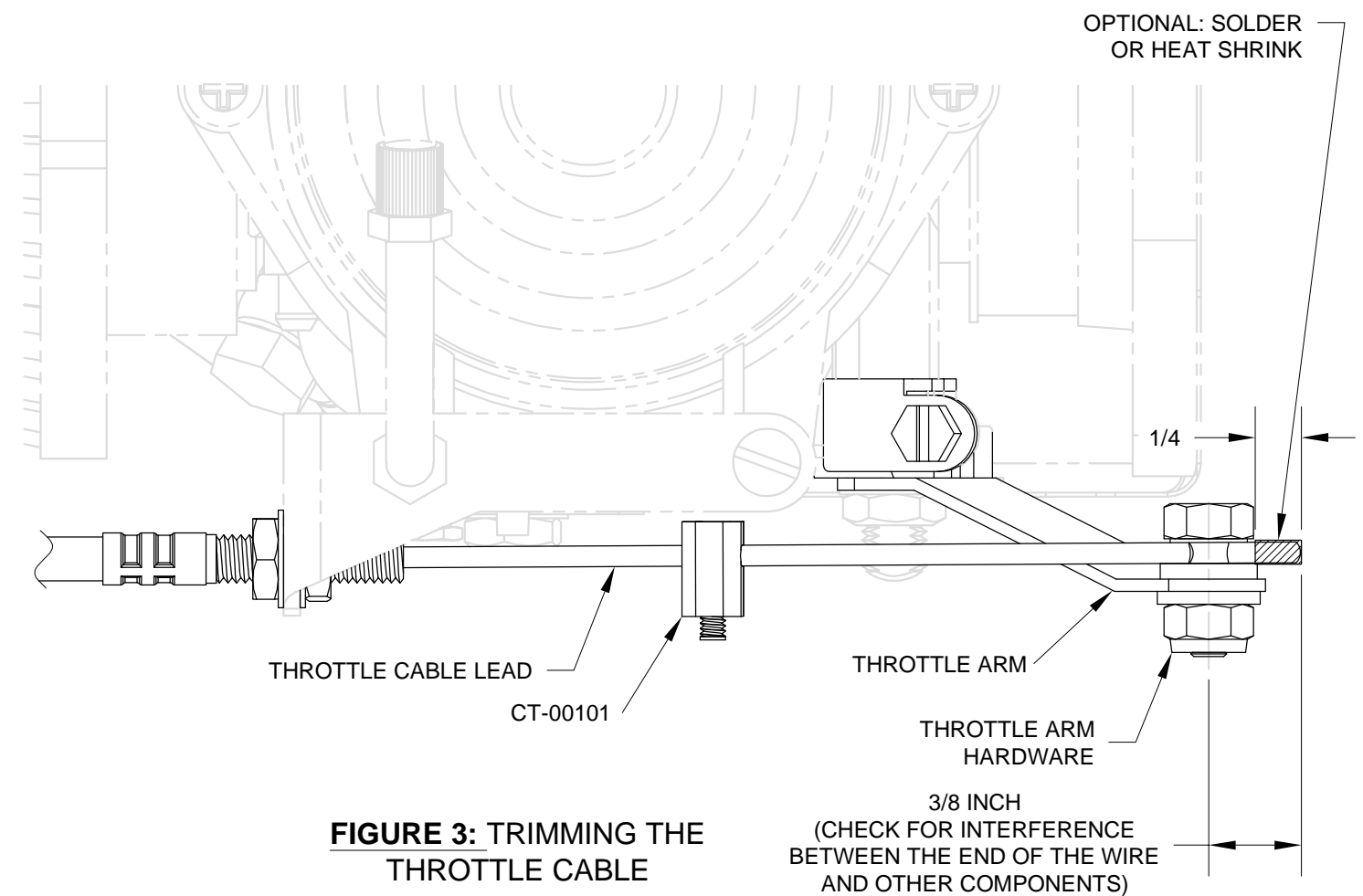

**FIGURE 3:** TRIMMING THE THROTTLE CABLE