

Step 1: Slide an insulated boot over the end of the WH-P155 (WHT) Starter Power Cable then attach the ring terminal to the power stud on the starter using the hardware called out in Figure 1. Torque the 6mm hex nut to 35 in-lbs. Slide the insulated boot into place. See Figure 1.

Step 2: Use the hardware shown in Figure 1 to connect the WH-P151 (WHT) Engine Ground Cable to the remaining lug on the starter.

ADJUST WH-P151 (WHT) TO PREVENT CHAFING. ADD HIGH TEMP RTV AS REQUIRED.

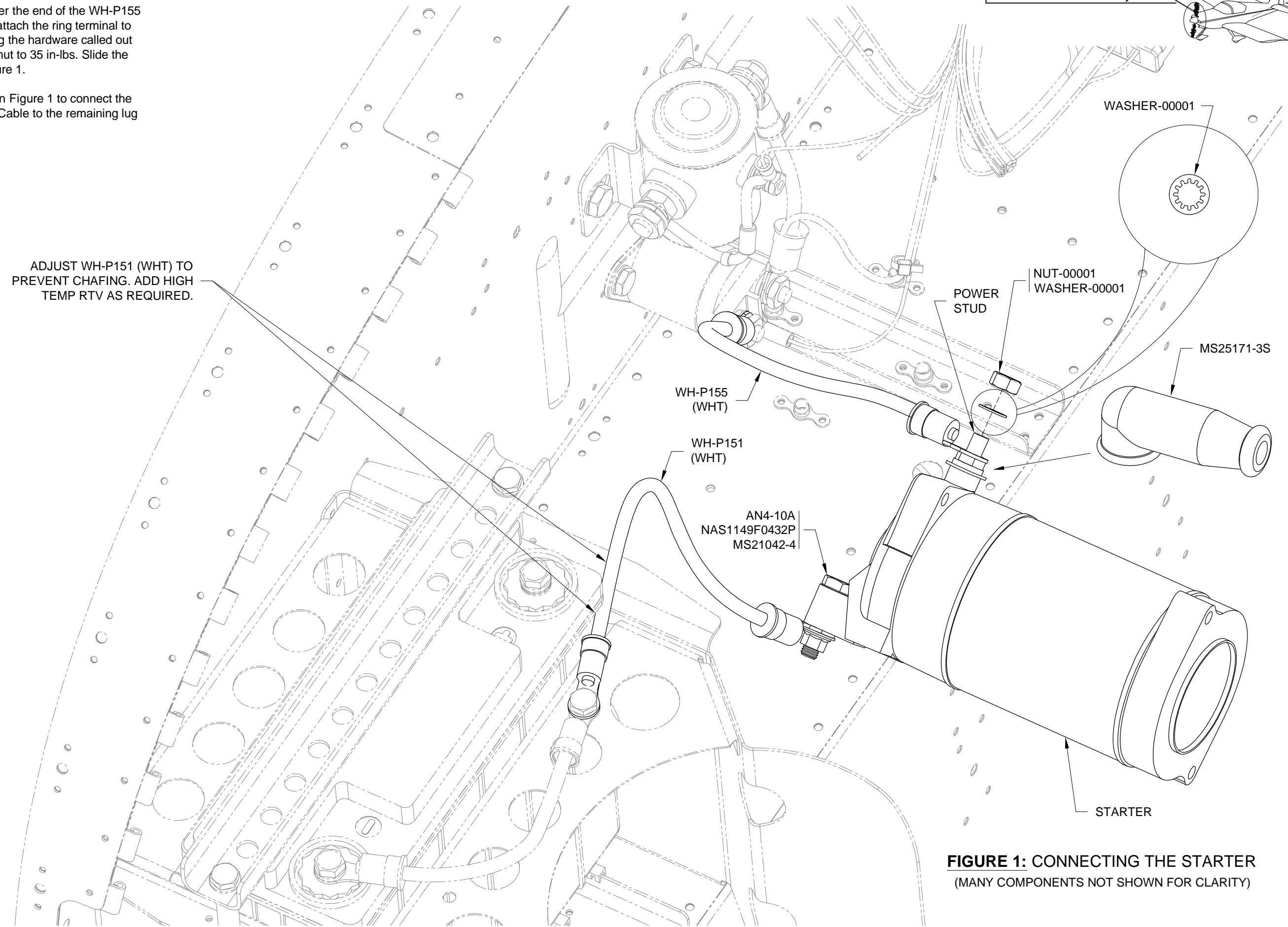

FIGURE 1: CONNECTING THE STARTER
(MANY COMPONENTS NOT SHOWN FOR CLARITY)