

Step 1: Strip the end of the 453-0023 Ground Wire (BLK).

Step 2: Crimp a ring terminal called out in Figure 1 on one end of the 453-0023 Ground Wire (BLK).

Step 3: Add a new battery to the 453-0023 Self Powered Cockpit Remote Switch per the instructions supplied with the ELT.

Step 4: Attach the 453-0023 Self Powered Cockpit Remote Switch to the F-1202U Inst Panel Right Mapbox. See Figure 1, using the instructions supplied with the ELT.

Step 5: Attach the ES RS 279-374 Phone Cable to the back of the 453-0023 Self Powered Cockpit Remote Switch as shown in Figure 1.

Step 6: Remove the aft right screw holding the right ES CPU FAN to the F-1202B Panel Base. Place the ring terminal on the end of the 453-0023 Ground Wire (BLK) and the ground ring terminal for the fan over the shank of the screw, then replace the screw.

Step 7: Tie-wrap the 453-0023 Ground Wire (BLK) to the ES RS 279-374 Phone Cable in two places for strain relief as shown in Figure 1.

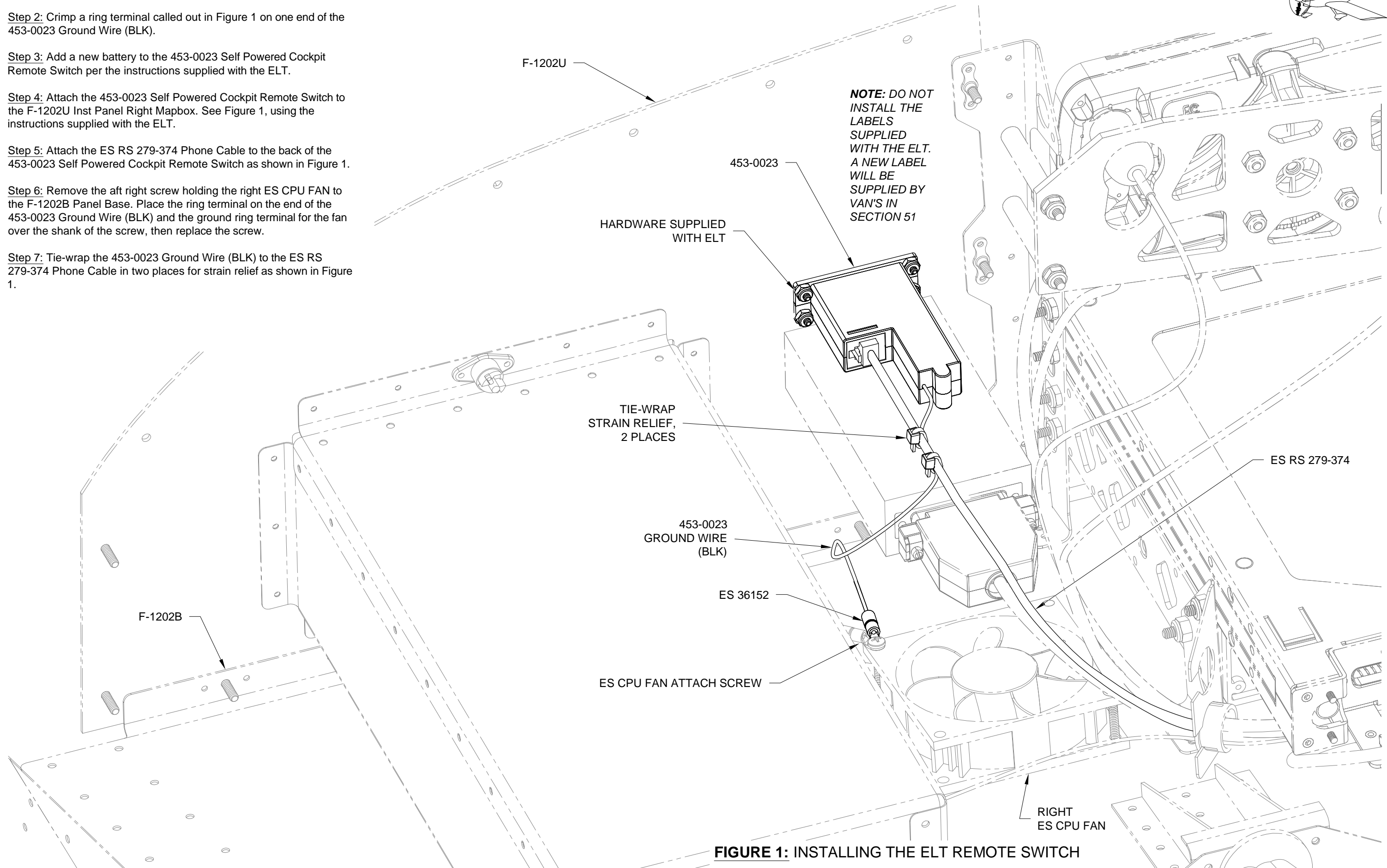

FIGURE 1: INSTALLING THE ELT REMOTE SWITCH