

Step 1: Remove the vinyl protective covering from both sides of the T-1210 Fuel Window, then deburr the edges.

Step 2: Use a toothpick to thinly coat the surface under the head of all the screws that will be used in installing the T-1210 Fuel Window with fuel tank sealant.

Step 3: Install two screws into the T-1201 Main Tank Skin in the locations called out in Figure 1. Tape over the screw heads to hold them in place then tip the tank on its side with the screw heads against a flat surface.

Step 4: Apply a thin layer of tank sealant along the perimeter of the T-1210 Fuel Window on one side.

Step 5: Apply a thin layer of sealant to the flanges of the T-1213-1 Backing Plate then carefully place the backing plate onto the side of the T-1210 Fuel Window without fuel tank sealant. Reach into the tank and slide the assembly in place over the two screws, then tip the tank upright.

Step 6: Insert the rest of the screws into the remaining holes attaching the T-1210 Fuel Window. Remove the tape from the two screws used as guides.

Step 7: Install the washers and nuts that attach the T-1210 Fuel Window and T-1213-1 Backing Plate to the T-1201 Main Tank Skin **finger tight**. Cover the nuts with fuel tank sealant. If using a nut driver to hold the nuts do not tighten the nuts using the handle. Tighten with the shank using fingers only.

NOTE: Do not attempt to remove any sealant squeezed out at the sight window holes until it is fully cured.

Step 8: Cut the end off of a popsicle stick so it is straight rather than round, then bevel the edge so it can be used as a scraper. After the sealant has cured use this tool to remove any sealant that may have oozed out of the sight window holes.

Step 9: Place a blanket or large rag over the inside bottom of the fuel tank to collect drill chips from following steps. Cleco the T-1204A Top Tank Skin to the Fuel Tank Assembly as shown in Figure 2.

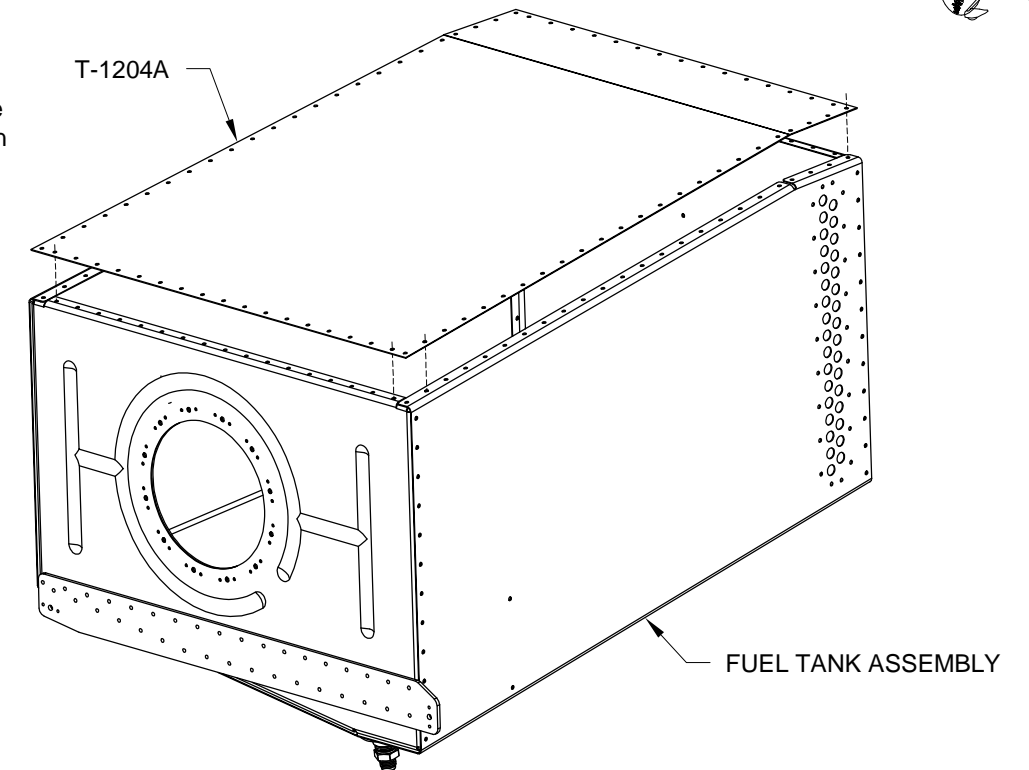

FIGURE 2: CLECO THE TOP TANK SKIN

Step 10: Layout and drill #30 a hole pattern in the flange of the T-1204B Flange per the dimensions given in Figure 3.

CAUTION: Avoid causing deformation to the T-1211 Fuel Neck and T-1204B Fuel Flange when tightening the hose clamps.

Step 11: Use two hose clamps and the T-1212 Fuel Neck Collar to join the T-1211 Fuel Neck and T-1204B Flange together per the dimensions called out in Figure 3.

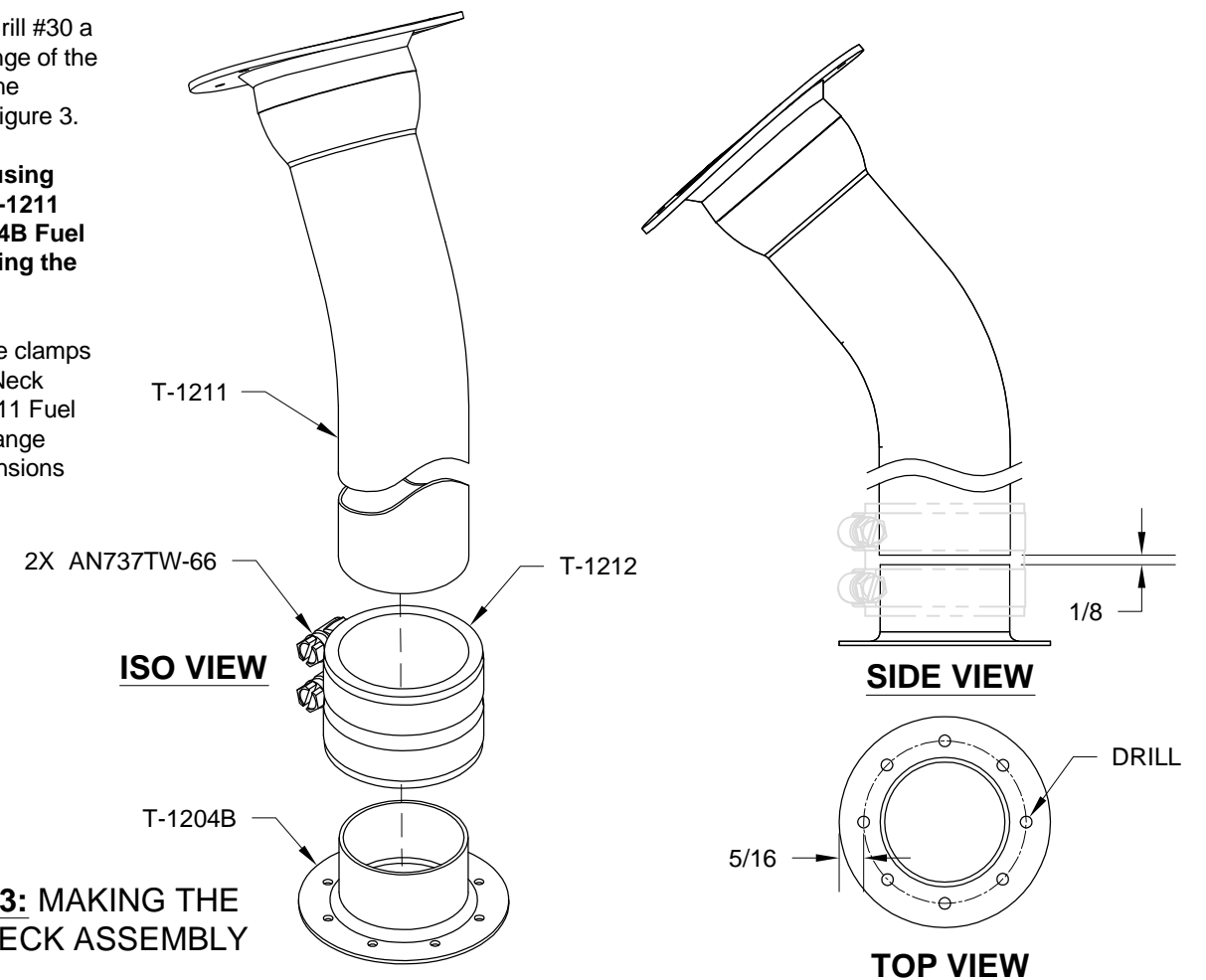

FIGURE 3: MAKING THE FILLER NECK ASSEMBLY

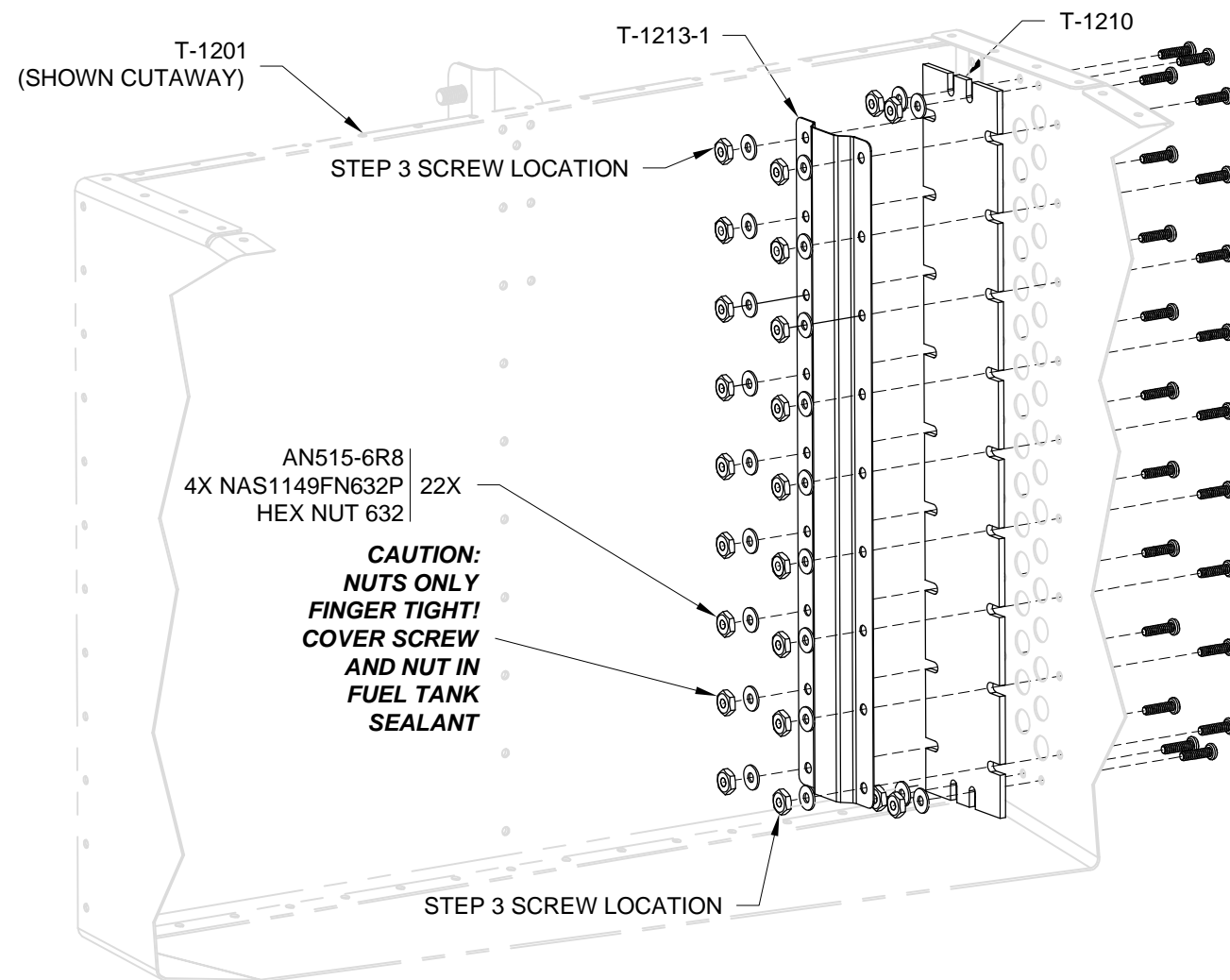

FIGURE 1: INSTALLING THE FUEL WINDOW